

We present:

# NOVELTIES

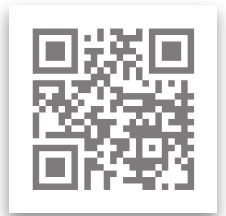

## ■ Bathroom construction – Construction panel for underfloor heating – LUX ELEMENTS<sup>®</sup>-FLOOR-WH F

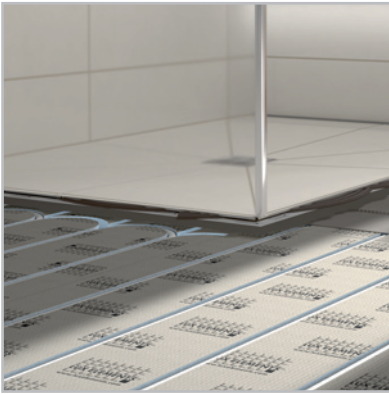

- Hard foam support element with milling for installing underfloor heating pipes under ceramic surfaces
- Installation and insulating element in one
- Low installation heights – ideal for renovations
- Quick and easy installation
- No screed necessary
- Short drying times during renovation
- Rapid heating of the room due to direct heat dissipation into the ceramic top covering
- Suitable for water heating with pipe diameter 16 mm
- Simple to process for adaptation to room situation

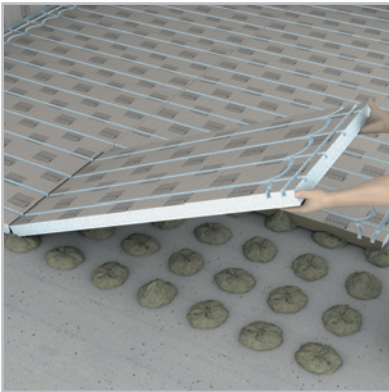

FLOOR-WH F ... is suitable for use on either wooden floors or mineral substrates such as concrete or screed. Using FLOOR-WH F 30 the fixing adhesive must always be applied over the full surface, FLOOR-WH F 50 can also be placed on dots (dots spacing  $\leq$  200 mm). For wooden floors, full coverage adhesion is always required.

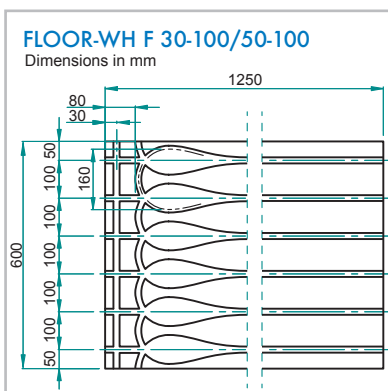
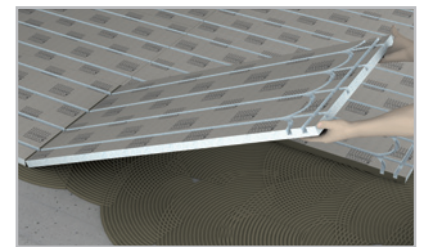
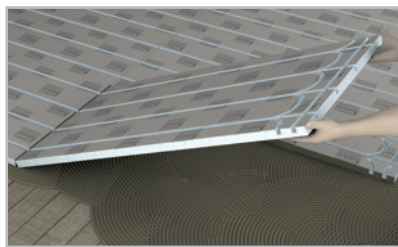

### Now also available in the variant:

FLOOR-WH F 30-100 and FLOOR-WH F 50-100

- 1250 x 600 mm, panel thickness 30 and 50 mm,  
Distance for laying the heating pipes 100 mm

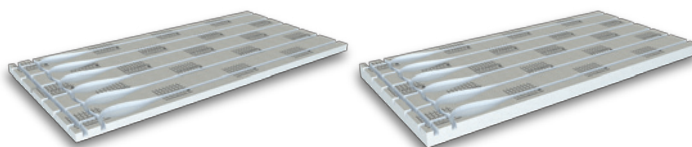

■ Bathroom construction – Adhesives – **LUX ELEMENTS®-COL**



Fixing adhesive – COL-AK

- Ready-mixed dry mortar
- For the attachment, levelling and adhesion of LUX ELEMENTS® hard foam support elements
- Stable, fast bonding, waterproof
- Low on chromate in accordance with EC directive 2003/53/EC

**Changed container size:**

Now available as a 15 kg bag only

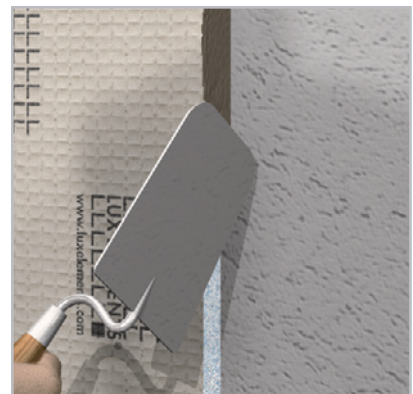
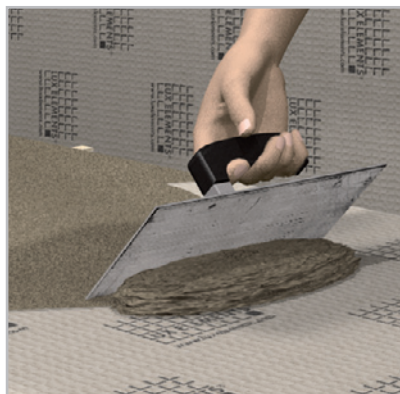
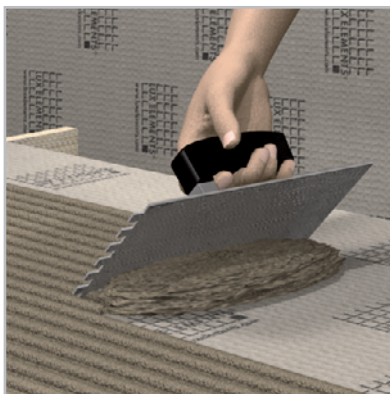

■ Bathroom construction – Fastening sets and dowels – **LUX ELEMENTS®-FIX**



Hard plastic insert – FIX PRO-MAK

- For adhering to hard foam
- For the stable fastening, for example, of hose holders or fittings
- Available in the sizes:
  - 100 x 100 mm, 100 x 200 mm and 200 x 200 mm

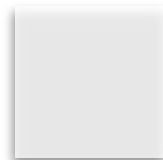
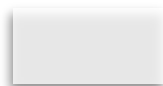
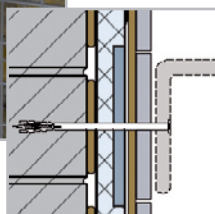



## ■ Showers – LUX ELEMENTS®-TUB – Systems on unfinished floors in screed

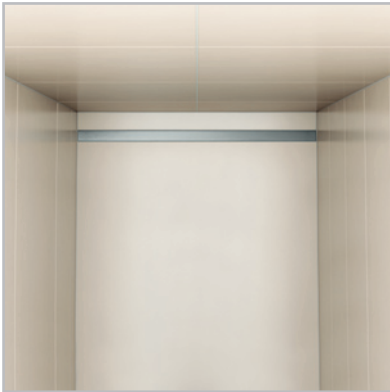

### Linear drainage with extended cover rail **TUB-LINE ... V RT**

- Continuous wall-to-wall channel look
- Can be shortened to fit the shower area
- Height-adjustable for optimum adaptation to covering thickness
- For barrier-free construction
- Second drainage level
- Secure click system for fastening the drain connection fitting
- Suitable drain systems

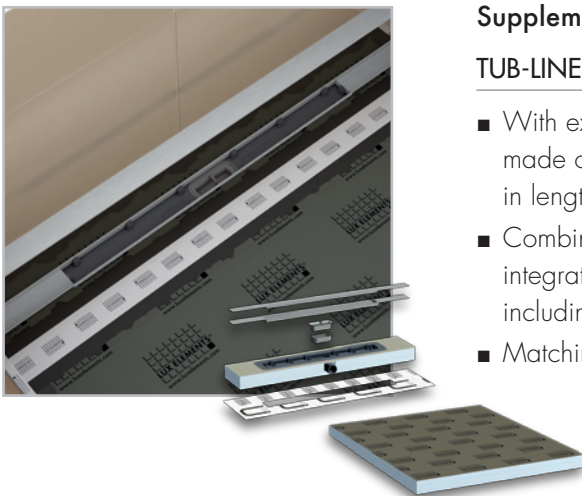

### Supplemented by new formats:

#### TUB-LINE COMBI V RT

- With extended cover rail (non-reversible) and extended tiling aid made of brushed stainless steel for continuous wall-to-wall channel look in length of 800, 900, 1000, 1100, 1200 or 1800 mm
- Combination of floor channel drain (70 x 650 mm or 70 x 850 mm) integrated in hard foam support element and horizontal drain support, including sealing sleeve
- Matching gradient elements TUB-LINE COMBI GK



### Supplemented by new formats:

#### TUB-LINE V RT

- With extended cover rail (non-reversible) and extended tiling aid made of brushed stainless steel for continuous wall-to-wall channel look in length of 800, 900, 1000, 1100, 1200 or 1800 mm
- Floor channel drain 70 x 650 mm or 70 x 850 mm integrated in hard foam support element, with substrate element and sealing sleeve
- Matching gradient elements TUB-LINE GK
- Matching substrate elements TUB-U with a height of 55 mm



■ Showers – **LUX ELEMENTS**<sup>®</sup>-TUB – Systems on unfinished floors in screed



Shower drain element extra-flat  
with integrated drainage technology

**TUB-COMBI-S MQ SET 300**

- For the installation in screed floors with slope
- Combination of shower drain element and horizontal floor drain support (DN 40)
- Including loose sealing sleeve
- Extra-flat shower base height: 55 mm
- For barrier-free construction
- Second drainage level
- Drainage capacity 0,8 l/s resp. 48 l/min
- Large selection of grate fitting frames (incl. standard or design grate)

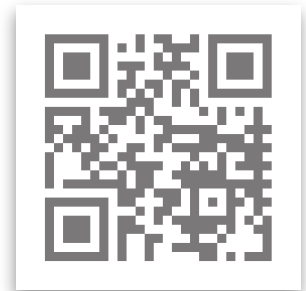

■ Showers – **LUX ELEMENTS**<sup>®</sup>-TUB – Systems on unfinished floors

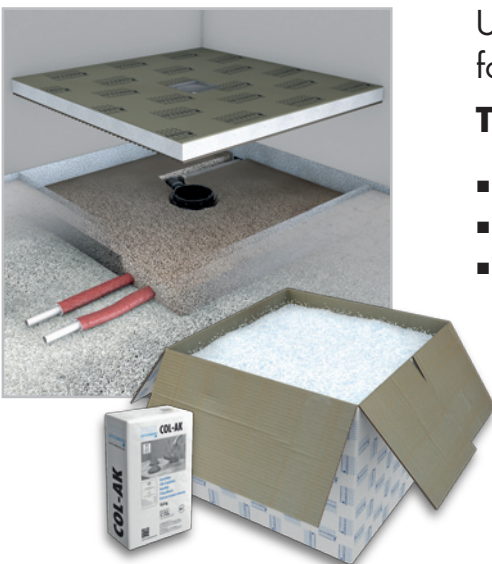

Universal substrate  
for TUB and TUB-LINE

**TUB-U S 90**

- Bonded levelling compound
- For height compensation of shower bases
- Consisting of:  
90 l 100% recycled EPS granulate and  
15 kg fixing adhesive COL-AK

**D**

LUX ELEMENTS GmbH & Co. KG  
An der Schusterinsel 7  
D - 51379 Leverkusen-Opladen

Tel. +49 (0) 21 71 / 72 12 - 0  
Fax +49 (0) 21 71 / 72 12 - 10

info@luxelements.de  
www.luxelements.com

**F**

LUX ELEMENTS S.A.S  
Zl-31, rue d'Ensisheim  
F - 68190 Ungersheim

Tél. +33 (0) 3 89 83 69 79  
Fax +33 (0) 3 89 48 83 27

info@luxelements.fr  
www.luxelements.fr